

Edgetech, Inc.
 11933 12th Avenue South
 Burnsville, MN 55337 USA
 952-881-1925
 fax 952-881-0374
www.EdgetechUSA.com

Manufacturer of Postforming and Laminating Machinery

Countertop Saw Specifications

Submit profiles for review. Some restrictions may apply to combinations of these dimensions.

Model		CTS730	CTS740-16	CTS740-20
Max. panel size (¾" thick board)	90°	45"	57"	53"
	22½°	42"	52"	49"
	45°	31"	40"	37"
Max. cutting height from bottom of countertop deck		5"	5"	7"
Max. cutting height including nose builddown		5¾"	5¾"	7¾"
Electrical requirement		208-230V / 3 Phase 35 Amp (40 Amp w/ 5 th Router)		
Air requirement		80 - 140 PSI	80 - 140 PSI	80 - 140 PSI
Machine working height		35½"	35½"	35½"
Machine height without laser (with laser)		67" (75")	67" (75")	69½" (77½")
Machine width x length		68" x 97"	84" x 113"	84" x 113"
Shipping weight (approximate)		2,000 lbs.	2,300 lbs.	2,500 lbs.

Production capacities and specifications are provided for the convenience of our customers and are not binding. Edgetech reserves the right to make changes without notice. Please contact us if the above capacities and/or specifications do not meet your requirements.

Engineering Floor Plans

CTS730 Countertop Saw

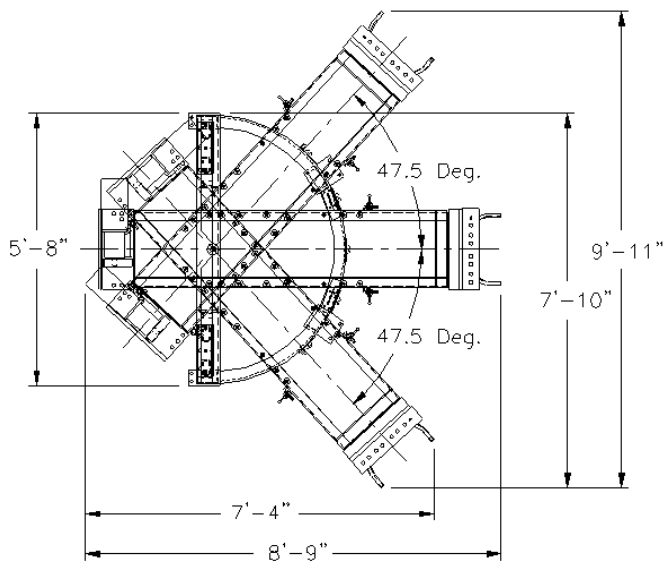

CTS740 Countertop Saw

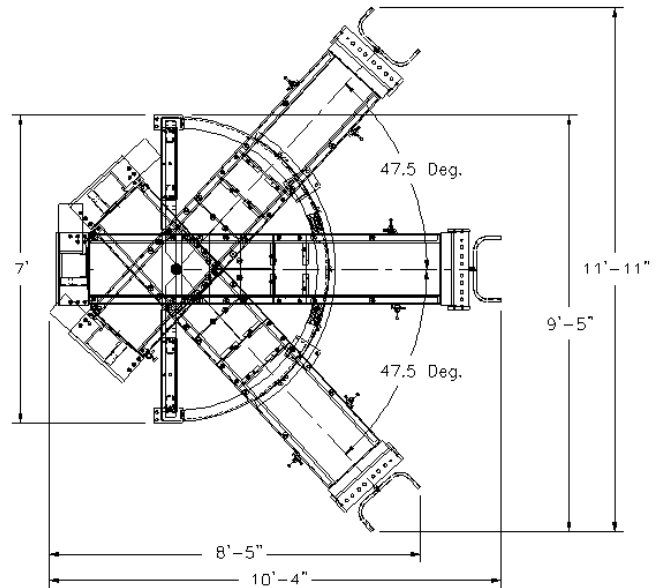

Note: Optional gravity conveyors are typically positioned at both sides of the saw base frame. The gravity conveyors are 10 feet long each, so the overall length including conveyors would be approximately 27 ft. (CTS730) or 28 ft. (CTS740).

